

*Strength
Endurance
Performance*

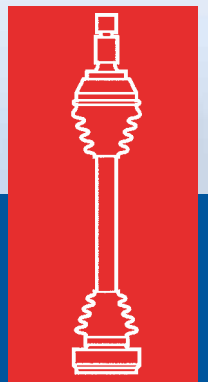



➤ Competence from the original manufacturer

GKN Land Systems is a diversified manufacturer and service supplier to the global agricultural, construction, mining and automotive industries.

GKN Aftermarkets & Services as part of the GKN Land Systems division is your preferred partner for driveline parts and systems, repair and maintenance, complete design and build of special drivelines.

GKN Aftermarkets & Services means supreme engineering competence combined with strong innovative ability and great responsibility for man and the environment.



➤ Strength, endurance and performance decide upon who wins the race.

This is true not only for the driver but also for the driveline components. Our extensive product range includes:

- super lightweight material hollow barshafts with rolled splines
- lightweight material sideshafts with latest GKN CV joint technology
- easy motion plunging CV joints
- uprated tripod joints
- advanced wheel hubs in titanium
- steel and titanium propshafts with high performance universal joints and high speed CV joints.





➤ Rolled Spline Barshafts

GKN Motorsport barshafts are

- used extensively in WRC, Touring Car, GT/LMP and Rallying applications
- individually designed and manufactured to suit each customer's requirements, from Formula Ford and Clubman Racing right through to WRC and beyond
- complemented by the extensive use of certified aerospace materials and incorporated hollow
- offering the ultimate in strength and weight
- available in a range of finishers.

Splines are rolled up to a shoulder which the CV joint can be pushed up to, eliminating the need for spacers. This process of cold rolling helps reduce the stress induced during manufacture in the critical area of spline run out, therefore increasing strength/fatigue resistance.

GKN barshafts can be manufactured as a solid barshaft or a gun drilled hollow barshaft, with bore diameters ranging from 12.5 mm to 20 mm.



➤ Constant Velocity Sideshafts

GKN CV sideshafts are manufactured to the highest quality for use in GKN Motorsport sideshafts. They are lightweighted, using the latest GKN CV joint technology.

Over 30 years of continuous development of GKN Driveline products, GKN Motorsport CV driveshafts joints offer

- **significant weight reduction**
- **cooler running temperatures**
- **enhanced joint life and performance.**

GKN is the world's leading supplier of automotive driveline components and systems. This enables GKN Motorsport to offer an unsurpassed range of standard, lightened and easy motion constant velocity joints able to cope with the most demanding applications.



➤ Constant Velocity Joints

Constant velocity plunging joints developed by GKN permit easy motion on both wheel and differential applications. On the back of many years of continuous development of GKN Driveline products, GKN Motorsport offers

- an unsurpassed range of standard, lightened and easy motion CV joints
- CV joints able to cope with the most demanding applications.

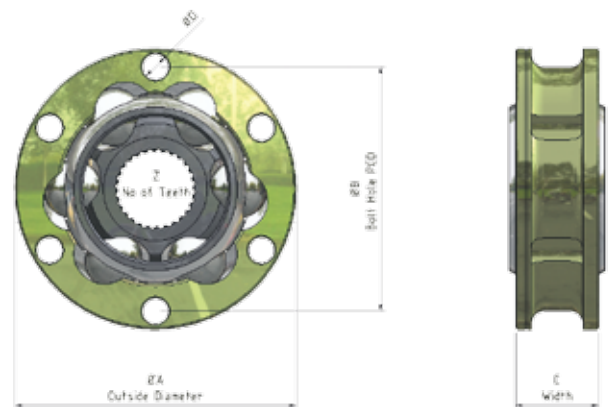

Some of the most popular CV joint sizes available are listed below. If the part you need is not listed please contact one of the GKN Motorsport facilities who will be happy to discuss your requirements.

Part number	Dimensions 'A'	Dimensions 'B'	Dimensions 'D'	Dimensions 'C'	Plunge Movement mm	Number of Teeth 'Z'	Comments
MS3J001	94 & 90	78	8	32	+/- 8	33	Standard, unmodified joint, Formula Ford
MS3J003	94 & 90	78	8	32	+/- 8	33	Lightweight & easy motion to suit Formula Ford
MS3K001	100	86	10	32	+/- 14	25	Lightweight & easy motion, WRC, Cosworth, front inner
MS3K002	100	86	10	32	+/- 20	25	Lightweight & easy motion, WRC, Cosworth, front inner
MS3K008	100	86	10	32	+/- 14	28	Lightweight & easy motion, WRC, Cosworth, front inner
MS3K020	100	86	8	32	+/- 8	25	Lightweight & easy motion, standard duty applications
MS3K023	100	86	8	32	+/- 8	25	Standard, unmodified joint, standard duty applications
MS3K025	100	86	10	32	+/- 8	25	Lightweight & easy motion, standard duty applications
MS3K031	100	86	8	32	+/- 8	33	Lightweight & easy motion. standard duty applications
MS3K032	100	86	10	32	+/- 8	28	Standard heavy duty joint with new ball hub
MS3K036	100	86	10	32	+/- 8	25	Lightweight & easy motion, standard duty applications
MS3K037	100	86	10	32	+/- 8	25	Lightweight & easy motion, heavy duty applications
MS3K038	100	86	8	32	+/- 8	25	Lightweight & easy motion, heavy duty applications
MS3N001	108	94	10	32	+/- 8	28	Escort Cosworth inboard/outboard joint rear
MS3N014	108	94	10	40	+/- 14	28	Lightweight & easy motion, deep plunge
MS3N020	108	94	10	32	+/- 8	28	Endurance joint, contoured outer race
MS3N042	108	94	10	32	+26 -22	28	Standard unmodified joint, extra deep plunge, wide ball hub
MS3N044	108	94	10	32	+/- 13	28	Lightweight & easy motion, deep plunge
MS3N045	108	94	10	32	+/- 20	28	Lightweight & easy motion, deep plunge
MS3N046	108	94	10	32	+/- 14	28	Contoured outer profile for heat reduction, easy motion
MS3S001	115	100	12	32	+/- 8	30	Standard unmodified joint
MS3S002	115	100	12	32	+/- 8	30	Contoured outer profile for heat reduction, Porsche GT 2/3
MS3S011	115	100	12	32	+/- 8	30	Easy motion joint

➤ GKN Tripod Boots and Greases

Especially developed for use with GKN CV and tripod joints GKN Motorsport greases help reduce power losses and increase durability, while offering low friction and wear properties and a wide thermal operating range.

GKN Motorsport ball joint grease has ultra high load carrying capacity and optimised viscosity and is suitable for all fixed and plunging (LÖBRO) CV joints.

The tripod grease is optimised for tripod lubrication, has high scuffing resistance but does not contain any solid additives (which can reduce life by jamming the needle bearings).

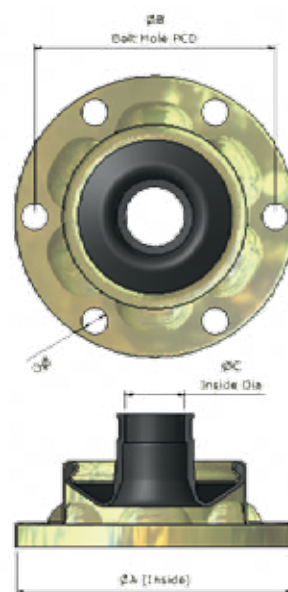

Part number	Dimensions 'A' mm	Dimensions 'B' mm	Dimensions 'C' mm	Dimensions 'D' mm	Comments
MS6J002	93	80	22	8.2	'Fast' boot and plate to suit ø 94 mm CV joints and tripod housings
MS6K023	99	86	22	8.2	'Fast' boot and plate to suit ø 100 mm CV joints and tripod housings (no indents)
MS6K012	99	86	22	8.2	'Fast' boot and plate to suit ø 100 mm CV joints and tripod housings
MS6K024	99	86	22	8.2	'Fast' boot and plate to suit ø 100 mm CV joints and tripod housings (with indents)
MS6K032	88	86	22	10.2	'Fast' boot and plate to suit ø 100 mm CV joints and tripod housings (with indents)
MSGN001	107	94	22	10.2	'Fast' boot and plate to suit ø 108 mm CV joints and tripod housings
MS6N003	107	94	25	10.2	'Fast' boot and plate to suit ø 108 mm CV joints and tripod housings
MS6N011	107	94	22	10.2	'Fast' boot and plate to suit ø 108 mm CV joints and tripod housings (high angle)
MS6S002	114	100	25	10.5	'Fast' boot and plate to suit ø 115 mm CV joints and tripod housings
MS6S008	115	100	25	10.5	'Slow' boot and plate to suit ø 115 mm CV joints and tripod housings
MS6S009	114	100	25	10.5	'Slow' boot and plate to suit ø 115 mm CV joints and tripod housings

The correct type and size of the boot is a vital part of the driveline assembly. GKN Motorsport boots are maximised for performance and durability. Please contact one of the GKN Motorsport facilities for more information on boots for fixed joints and boots utilising other materials. Our most popular part numbers are listed above.



➤ GKN Tripod Journals & Housings

Using the vast experience GKN have gained developing and manufacturing tripod applications for OEM customers around the world. GKN motorsport can offer a wide range of tripod journals and bespoke tripod housings to suit almost every situation.

Tripod joints offer extremely low plunging forces and greater efficiency while operating at higher angles. Housings can be produced from forgings or from solid material and can be designed to utilise a LÖBRO style bolt pattern making CV to tripod switch simple, or alternatively a “plug in” variant.

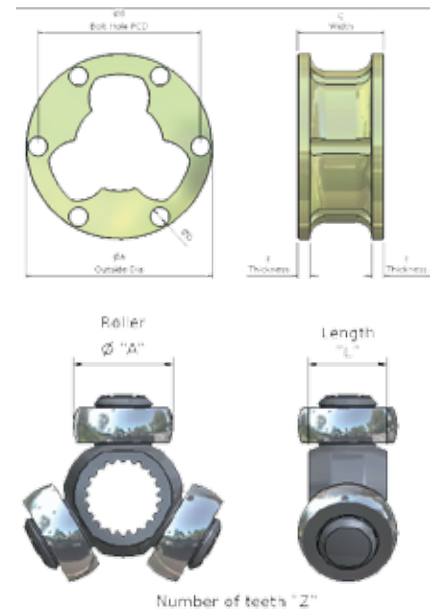

Part number	Dimensions 'A' mm	Dimensions 'B' mm	Dimensions 'C' mm	Dimensions 'D' mm	Dimensions 'E' mm	Dimensions 'L' mm	Number of Teeth 'Z'	Comments
MS3H001	29.95					23.5	22	GI69 tripod
MS3H002	29.95					23.5	30	GI69 tripod
MS3H003	29.95					23.5	23	GI69 tripod
MS3H004	29.95					24.5	22	GI69 tripod – white body
MS3H005	35.50					27	24	GI2600i tripod
MS3H006	30.42					24	21	GI1700i tripod
MS3H007	33.90					26.6	23	GI2300i tripod
MS3M001	33.90					30	27	GI82 tripod
MS3M002	33.90					30	27	GI82 tripod – shot peened
MS3M008	38.00					29.2	26	GI3300i tripod
MS9H009		78	40	8	90/94		n/a	6 holes unequally spaced in pairs
MS9H010		78	32	8	90/94		n/a	To suit GI69 tripods, other widths available
MS9M01-040		94	40	10	108		n/a	To suit GI82 tripods, other widths available





Strength . Endurance . Performance

If your next project demands superior performance talk to the specialists at GKN Motorsport:

GKN Service International GmbH
Mühlheimer Straße 163
63075 Offenbach
Germany
Tel.: +49 (0)69 8904 2011
Fax: +49 (0)69 8904 2015
Email: gerd.kraehe@gkn.com

GKN Driveline Service Ltd.
Unit 5, Kingsbury Business Park
Minworth, Sutton Coldfield
West Midlands B76 9DL
United Kingdom
Tel.: +44 121 313 1661
Fax: +44 121 313 2075
Email: sales@gkndriveline.com

GKN Motorsport specialise in the design and manufacture of driveline products for all areas of motorsport, from clubman through to professional teams.

Please contact us for all of your 4x4, front wheel drive and rear wheel drive requirements.



GKN Land Systems
Aftermarkets & Services

Headquarters:
GKN Service International GmbH
Nussbaumweg 19-21
51503 Rösrath, Germany
www.gknservice.com

© GKN Driveline. All rights reserved.

